

Stainless Steel Inserts – Eccentric Locking Collar

- 440 Stainless Steel
- Wide Inner Rings
- Dual Seal
- Lubricated with (H1) Food Grade Grease

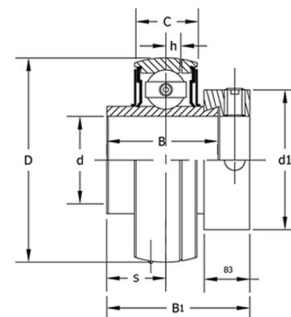

Bearing Designation	Shaft Diameter (d)	Outer Diameter (D)	Width (B ₁)	Inner Width (B)	Outer Ring Width (C)	Bearing Inner Race Width - Short Side (S)	Bearing Center to Oil Hole Center (h)	(B ₂)	(D ₁)	Bearing Collar Set Screw (ds)	Weight (lb)	Basic Dynamic Load Rating lbs	Basic Static Load Rating lbs
SSHC201-12MM	0.4724	1.8504	1.7205	1.3465	0.6693	0.6732	0.1890	0.5315	1.3110	1/4-28UNF	0.64	2877.55	1494.98
SSHC201-8	0.5000	1.8504	1.7205	1.3465	0.6693	0.6732	0.1890	0.5315	1.3110	1/4-28UNF	0.64	2877.55	1494.98
SSHC202-15MM	0.5906	1.8504	1.7205	1.3465	0.6693	0.6732	0.1890	0.5315	1.3110	1/4-28UNF	0.6	2877.55	1494.98
SSHC202-10	0.6250	1.8504	1.7205	1.3465	0.6693	0.6732	0.1890	0.5315	1.3110	1/4-28UNF	0.57	2877.55	1494.98
SSHC203-17MM	0.6693	1.8504	1.7205	1.3465	0.6693	0.6732	0.1890	0.5315	1.3110	1/4-28UNF	0.55	2877.55	1494.98
SSHC203-11	0.6875	1.8504	1.7205	1.3465	0.6693	0.6732	0.1890	0.5315	1.3110	1/4-28UNF	0.55	2877.55	1494.98
SSHC204-20MM	0.7874	1.8504	1.7205	1.3465	0.6693	0.6732	0.1890	0.5315	1.3110	1/4-28UNF	0.51	2877.55	1494.98
SSHC204-12	0.7500	1.8504	1.7205	1.3465	0.6693	0.6732	0.1890	0.5315	1.3110	1/4-28UNF	0.51	2877.55	1494.98
SSHC205-25MM	0.9843	2.0472	1.7480	1.3740	0.6693	0.6890	0.1890	0.5315	1.5000	1/4-28UNF	0.6	3147.33	1764.75
SSHC205-14	0.8750	2.0472	1.7480	1.3740	0.6693	0.6890	0.1890	0.5315	1.5000	1/4-28UNF	0.68	3147.33	1764.75
SSHC205-15	0.9375	2.0472	1.7480	1.3740	0.6693	0.6890	0.1890	0.5315	1.5000	1/4-28UNF	0.64	3147.33	1764.75
SSHC205-16	1.0000	2.0472	1.7480	1.3740	0.6693	0.6890	0.1890	0.5315	1.5000	1/4-28UNF	0.6	3147.33	1764.75
SSHC206-30MM	1.1811	2.4409	1.9055	1.4370	0.7480	0.7205	0.2362	0.6260	1.7520	5/16-24UNF	0.99	4386.02	2540.34
SSHC206-17	1.0625	2.4409	1.9055	1.4370	0.7480	0.7205	0.2362	0.6260	1.7520	5/16-24UNF	1.1	4386.02	2540.34
SSHC206-18	1.1250	2.4409	1.9055	1.4370	0.7480	0.7205	0.2362	0.6260	1.7520	5/16-24UNF	1.04	4386.02	2540.34
SSHC206-19	1.1875	2.4409	1.9055	1.4370	0.7480	0.7205	0.2362	0.6260	1.7520	5/16-24UNF	0.99	4386.02	2540.34
SSHC206-20	1.2500	2.4409	1.9055	1.4370	0.7480	0.7205	0.2362	0.6260	1.7520	5/16-24UNF	0.93	4386.02	2540.34
SSHC207-35MM	1.3780	2.8346	2.0118	1.4803	0.7874	0.7402	0.2677	0.6890	2.1890	5/16-24UNF	1.32	5777.59	3439.58
SSHC207-20	1.2500	2.8346	2.0118	1.4803	0.7874	0.7402	0.2677	0.6890	2.1890	5/16-24UNF	1.48	5777.59	3439.58
SSHC207-21	1.3125	2.8346	2.0118	1.4803	0.7874	0.7402	0.2677	0.6890	2.1890	5/16-24UNF	1.39	5777.59	3439.58
SSHC207-22	1.3750	2.8346	2.0118	1.4803	0.7874	0.7402	0.2677	0.6890	2.1890	5/16-24UNF	1.32	5777.59	3439.58
SSHC207-23	1.4375	2.8346	2.0118	1.4803	0.7874	0.7402	0.2677	0.6890	2.1890	5/16-24UNF	1.26	5777.59	3439.58
SSHC208-40MM	1.5748	3.1496	2.2165	1.6850	0.8268	0.8425	0.2677	0.7205	2.3740	5/16-24UNF	1.74	6631.86	4069.04
SSHC208-24	1.5000	3.1496	2.2165	1.6850	0.8268	0.8425	0.2677	0.7205	2.3740	5/16-24UNF	1.85	6631.86	4069.04
SSHC208-25	1.5625	3.1496	2.2165	1.6850	0.8268	0.8425	0.2677	0.7205	2.3740	5/16-24UNF	1.76	6631.86	4069.04
SSHC209-45MM	1.7717	3.3465	2.2165	1.6850	0.8661	0.8425	0.2677	0.7205	2.5000	5/16-24UNF	1.87	7103.96	4631.06
SSHC209-26	1.6250	3.3465	2.2165	1.6850	0.8661	0.8425	0.2677	0.7205	2.5000	5/16-24UNF	2.12	7103.96	4631.06
SSHC209-27	1.6875	3.3465	2.2165	1.6850	0.8661	0.8425	0.2677	0.7205	2.5000	5/16-24UNF	2.01	7103.96	4631.06
SSHC209-28	1.7500	3.3465	2.2165	1.6850	0.8661	0.8425	0.2677	0.7205	2.5000	5/16-24UNF	1.92	7103.96	4631.06
SSHC210-50MM	1.9685	3.5433	2.4685	1.9370	0.9449	0.9685	0.2677	0.7205	2.7520	5/16-24UNF	2.18	7868.31	5215.57
SSHC210-30	1.8750	3.5433	2.4685	1.9370	0.9449	0.9685	0.2677	0.7205	2.7520	5/16-24UNF	2.38	7868.31	5215.57
SSHC210-31	1.9375	3.5433	2.4685	1.9370	0.9449	0.9685	0.2677	0.7205	2.7520	5/16-24UNF	2.25	7868.31	5215.57
SSHC210-32	2.0000	3.5433	2.4685	1.9370	0.9449	0.9685	0.2677	0.7205	2.7520	5/16-24UNF	2.12	7868.31	5215.57
SSHC211-55MM	2.1654	3.9370	2.8110	2.1850	0.9843	1.0945	0.3150	0.8150	3.0000	3/8-24UNF	2.91	9779.19	6564.42
SSHC211-32	2.0000	3.9370	2.8110	2.1850	0.9843	1.0945	0.3150	0.8150	3.0000	3/8-24UNF	3.35	9779.19	6564.42
SSHC211-34	2.1250	3.9370	2.8110	2.1850	0.9843	1.0945	0.3150	0.8150	3.0000	3/8-24UNF	3.02	9779.19	6564.42
SSHC211-35	2.1875	3.9370	2.8110	2.1850	0.9843	1.0945	0.3150	0.8150	3.0000	3/8-24UNF	2.84	9779.19	6564.42
SSHC212-60MM	2.3622	4.3307	3.0630	2.4370	1.0630	1.2205	0.3150	0.8780	3.3150	3/8-24UNF	4.14	10723.39	7396.21
SSHC212-36	2.2500	4.3307	3.0630	2.4370	1.0630	1.2205	0.3150	0.8780	3.3150	3/8-24UNF	4.5	10723.39	7396.21
SSHC212-38	2.3750	4.3307	3.0630	2.4370	1.0630	1.2205	0.3150	0.8780	3.3150	3/8-24UNF	4.19	10723.39	7396.21
SSHC212-39	2.4375	4.3307	3.0630	2.4370	1.0630	1.2205	0.3150	0.8780	3.3150	3/8-24UNF	3.9	10723.39	7396.21
SSHC213-65MM	2.5591	4.7244	3.3740	2.7008	1.1024	1.3425	0.3346	0.9252	3.3858	3/8-24UNF	5.31	12926.51	8992.36
SSHC213-40	2.5000	4.7244	3.3740	2.7008	1.1024	1.3425	0.3346	0.9252	3.3858	3/8-24UNF	5.53	12926.51	8992.36
SSHC214-43	2.6875	4.7244	3.3740	2.7008	1.1417	1.3425	0.3346	0.9252	3.3858	3/8-24UNF	5.91	13668.38	10116.4
SSHC214-44	2.7500	4.7244	3.3740	2.7008	1.1417	1.3425	0.3346	0.9252	3.3858	3/8-24UNF	5.64	13668.38	10116.4
SSHC215-75MM	2.9528	5.1181	3.6260	2.9528	1.1811	1.4685	0.3346	0.9252	4.0157	3/8-24UNF	6.26	14837.39	11128.04
SSHC215-47	2.9375	5.1181	3.6260	2.9528	1.1811	1.4685	0.3346	0.9252	4.0157	3/8-24UNF	6.35	14837.39	11128.04
SSHC215-48	3.0000	5.1181	3.6260	2.9528	1.1811	1.4685	0.3346	0.9252	4.0157	3/8-24UNF	6.04	14837.39	11128.04

TRITAN Insert bearings are designed for use in pillow block or flange units made to AFBMA standard and can be used in housings produced by most manufacturers. Ball Bearing mounted units using these Stainless Steel inserts are suitable for use in industrial and commercial applications that are subject to frequent wash-down, damp environments or harsh contaminants, in applications such as poultry, pharmaceutical processing, fishing, and chemical manufacturing.