

## Ball Thrust Bearing

Medium Cross Section

Grooved Races

Single Direction

Separable Axial Contact

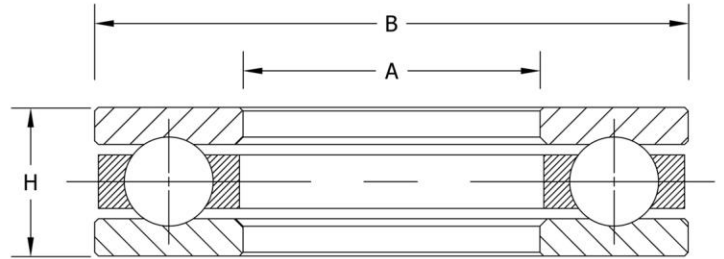

Bearing Designation	Bore Diameter (d)	Outside Diameter (D)	Width (T)	Dynamic Load C (Lbs)	Static Load Co (Lbs)	Limiting Speed Grease (RPM)	Limiting Speed Oil (RPM)	Weight Lbs
W1/4	0.250"	0.8130"	0.375"	1053	1170	12000	15000	0.040
W5/16	0.313"	1.0000"	0.531"	1719	2250	8800	11000	0.080
W3/8	0.375"	1.0000"	0.531"	1719	2250	8800	11000	0.080
W7/16	0.438"	1.2810"	0.625"	2835	4005	6400	8000	0.160
W1/2	0.500"	1.2810"	0.625"	2835	4005	6400	8000	0.150
W9/16	0.563"	1.4060"	0.625"	3915	5670	6400	8000	0.180
W5/8	0.625"	1.4060"	0.625"	3915	5670	6400	8000	0.170
W3/4	0.750"	1.5310"	0.625"	3150	4950	5600	7000	0.190
W7/8	0.875"	1.6560"	0.625"	3780	7020	4800	6000	0.220
W1	1.000"	1.7810"	0.625"	3375	5940	4400	5500	0.230
W1 1/8	1.125"	1.9060"	0.625"	3285	5940	4000	5000	0.250
W1 1/4	1.250"	2.0940"	0.719"	5400	10080	3760	4700	0.360
W1 3/8	1.375"	2.2190"	0.719"	5580	10890	3520	4400	0.380
W1 1/2	1.500"	2.3440"	0.719"	4320	8820	3280	4100	0.400
W1 5/8	1.625"	2.4690"	0.719"	5760	12510	3040	3800	0.430
W1 3/4	1.750"	2.6880"	0.750"	5850	13140	2880	3600	0.550
W1 7/8	1.875"	2.8130"	0.750"	5580	12510	2640	3300	0.560
W2	2.000"	2.9690"	0.750"	5580	12510	2560	3200	0.610
W2 1/8	2.125"	3.2190"	0.875"	7830	18000	2400	3000	0.770
W2 1/4	2.250"	3.3440"	0.875"	8280	20250	2240	2800	0.930
W2 3/8	2.375"	3.5940"	1.000"	11340	27450	2080	2600	1.290
W2 1/2	2.500"	3.7190"	1.000"	11160	27450	2080	2600	1.330
W2 5/8	2.625"	3.8440"	1.000"	10350	24300	2000	2500	1.400
W2 3/4	2.750"	4.0310"	1.000"	10890	27450	1840	2300	1.490
W2 7/8	2.875"	4.1560"	1.000"	10890	27450	1840	2300	1.540

US Corporate Headquarters:

2100 Pacific Street  
Hauppauge NY, 11788  
www.tritanpt.com



Exclusively Distributed by:



888-4-Bearings

## Ball Thrust Bearing

Bearing Designation	Bore Diameter (d)	Outside Diameter (D)	Width (T)	Dynamic Load C (Lbs)	Static Load Co (Lbs)	Limiting Speed Grease (RPM)	Limiting Speed Oil (RPM)	Weight Lbs
W3	3.000"	4.3750"	1.125"	15210	40050	1680	2100	2.020
W3 1/8	3.125"	4.5000"	1.125"	14940	40050	1600	2000	2.080
W3 1/4	3.250"	4.8130"	1.250"	18180	47700	1600	2000	2.500
W3 3/8	3.375"	4.9380"	1.250"	17640	45900	1520	1900	2.810
W3 1/2	3.500"	5.0630"	1.250"	17190	45900	1520	1900	2.880
W3 5/8	3.625"	5.1880"	1.250"	17190	45900	1440	1800	3.200
W3 3/4	3.750"	5.3130"	1.250"	17190	45900	1360	1700	3.300
W3 7/8	3.875"	5.6880"	1.375"	20880	55800	1360	1700	4.060
W4	4.000"	5.8130"	1.375"	20880	55800	1280	1600	4.150
W4 1/4	4.250"	6.3130"	1.750"	29700	81000	1200	1500	6.750
W4 1/2	4.500"	6.5000"	1.750"	29700	81000	1120	1400	7.850
W4 3/4	4.750"	7.0630"	2.000"	39600	108900	1040	1300	8.800
W5	5.000"	7.3130"	2.000"	38700	108900	1040	1300	10.10
W5 1/2	5.500"	8.0630"	2.125"	47700	139500	960	1200	13.71
W6	6.000"	8.6880"	2.375"	49500	144000	880	1100	16.70
W6 1/2	6.500"	9.4060"	2.500"	54000	162000	800	1000	20.33
W7	7.000"	10.125"	2.625"	59400	181800	720	900	25.00
W7 1/2	7.500"	10.875"	2.750"	63000	202500	680	850	29.98



**Materials:** Rings and balls are constructed of thru-hardened 52100 steel.

US Corporate Headquarters:

2100 Pacific Street  
Hauppauge NY, 11788  
[www.tritanpt.com](http://www.tritanpt.com)



Exclusively Distributed by:



888-4-Bearings