

Product Highlights

Rubber Mounted Pressed Steel Pillow Blocks

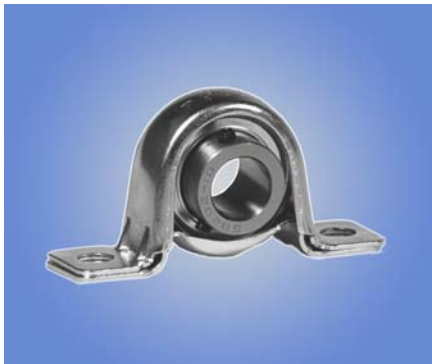

Rubber Mounted Pressed Steel RPB Pillow Blocks & Rubber encased RABR Inserts are designed for use in the HVAC industry.

RPB units consist of a two piece separable pressed steel housing (PB Housing) with a light duty ball bearing insert surrounded by a conductive rubber ring (RABR insert) to help eliminate noise and vibration.

Units are available with flush inner ring bearings constructed with full cover metal shroud seals and eccentric (self locking) collar. They are also available with dual set screw bearings (S suffix).

RABR inserts are also available as replacement bearings or for applications where they are used without the housing. Current stock sizes are 1/2", 17mm, 3/4", 20mm, 7/8", & 1" bores.

Unit Interchange

BL Part #	AMI #	Fafnir #	FYH #	Peer #
Eccentric Collar				
RPB16	KHPR205-16	RPB1	SARPP205-16	FHPRZ205-16
Set Screw				
RPB16S	BPR205-16	N/A	SPRPP205-16	FHSPRZ205-16

Insert Interchange

BL Part #	AMI #	Fafnir #	FYH #	Peer #
Eccentric Collar				
RABR16	KH205-16 + R6	RABR1	SAR205-16	FH205-16 + R6
Set Screw				
RABR16S	B5-16 + R6	N/A	SBR205-16	FHS205-16 + R6

Call your regional *Bearings Limited* office (1 888 4 BEARINGS) for up-to-date price and availability on the above sizes, as well as on the complete Insert & Mounted Unit range.