

3000 Series Double Row Angular Contact Bearings

The light series double row design provides for higher load capacity in applications where space is constrained. These double-row angular contact ball bearings are ideal for high combined loads from the radial and axial directions.

- 25-degree contact angle
- Narrower than two comparable single row angular ball bearings side by side
- Suitable for high radial loads and axial loads in both directions with high running accuracy, and quiet running at high speeds
- Fiberglass reinforced nylon cage providing low weight and the elasticity resulting in quiet performance and increased shock resistance
- Full contact rubber seal on both sides (2RS)

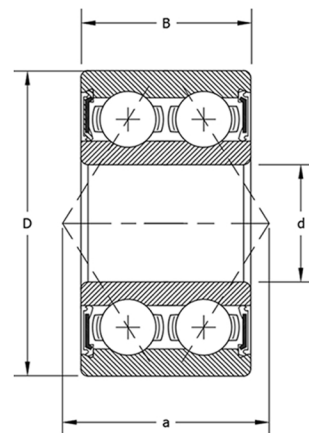

Bearing Designation	Bore Diameter (D)	Outside Diameter (D)	Width (B)	Dynamic Load C (Lbs)	Static Load Co (Lbs)	Limiting Speed Grease (RPM)
3000 2RS	10mm	26mm	12mm	1220	680	18100
3001 2RS	12mm	28mm	12mm	1300	790	15800
3002 2RS	15mm	32mm	13mm	1815	1150	13000
3003 2RS	17mm	35mm	14mm	1940	1300	12300
3004 2RS	20mm	42mm	16mm	3050	2010	10500
3005 2RS	25mm	47mm	16mm	3250	2340	8800
3006 2RS	30mm	55mm	19mm	4250	3290	7400

4200 Series Double Row Bearings

These 4200 series bearings have a higher load capacity than comparable single row deep groove ball bearings but are only slightly wider.

- Light series with compact dimensions and low weight
- Fiberglass reinforced nylon cage providing low weight and the elasticity resulting in quiet performance and increased shock resistance
- Suitable for very high radial loads and light axial loads in both directions, providing high running accuracy, and quiet running at high speeds
- Full contact rubber seal on both sides (2RS)

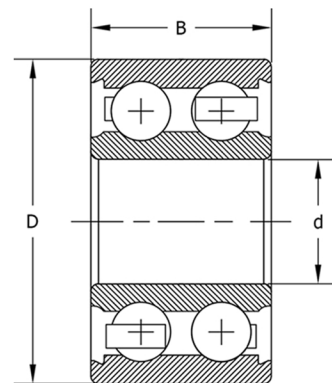

Bearing Designation	Bore Diameter (D)	Outside Diameter (D)	Width (B)	Dynamic Load C (Lbs)	Static Load Co (Lbs)	Limiting Speed Grease (RPM)
4200 2RS	10mm	30mm	14mm	2057	1169	24000
4201 2RS	12mm	32mm	14mm	2091	1236	20000
4202 2RS	15mm	35mm	14mm	2338	1506	18000
4203 2RS	17mm	40mm	16mm	3282	2136	17000
4204 2RS	20mm	47mm	18mm	4047	2855	14000
4205 2RS	25mm	52mm	18mm	4339	3282	12000
4206 2RS	30mm	62mm	20mm	5845	4676	9500